

PRINTABLE INFO SHEET

**Series: Aurora Classic Ranch
Modular
Model: AU230A Aurora Signature**



About This Model

Style: Ranch / Bedrooms: 3 / Bathrooms: 2 / Square Feet: 1859

CUSTOMER CONTACT

Notes:

PRINTABLE INFO SHEET

Series: Aurora Classic Ranch
 Modular
 Model: AU230A Aurora Signature



Floorplan

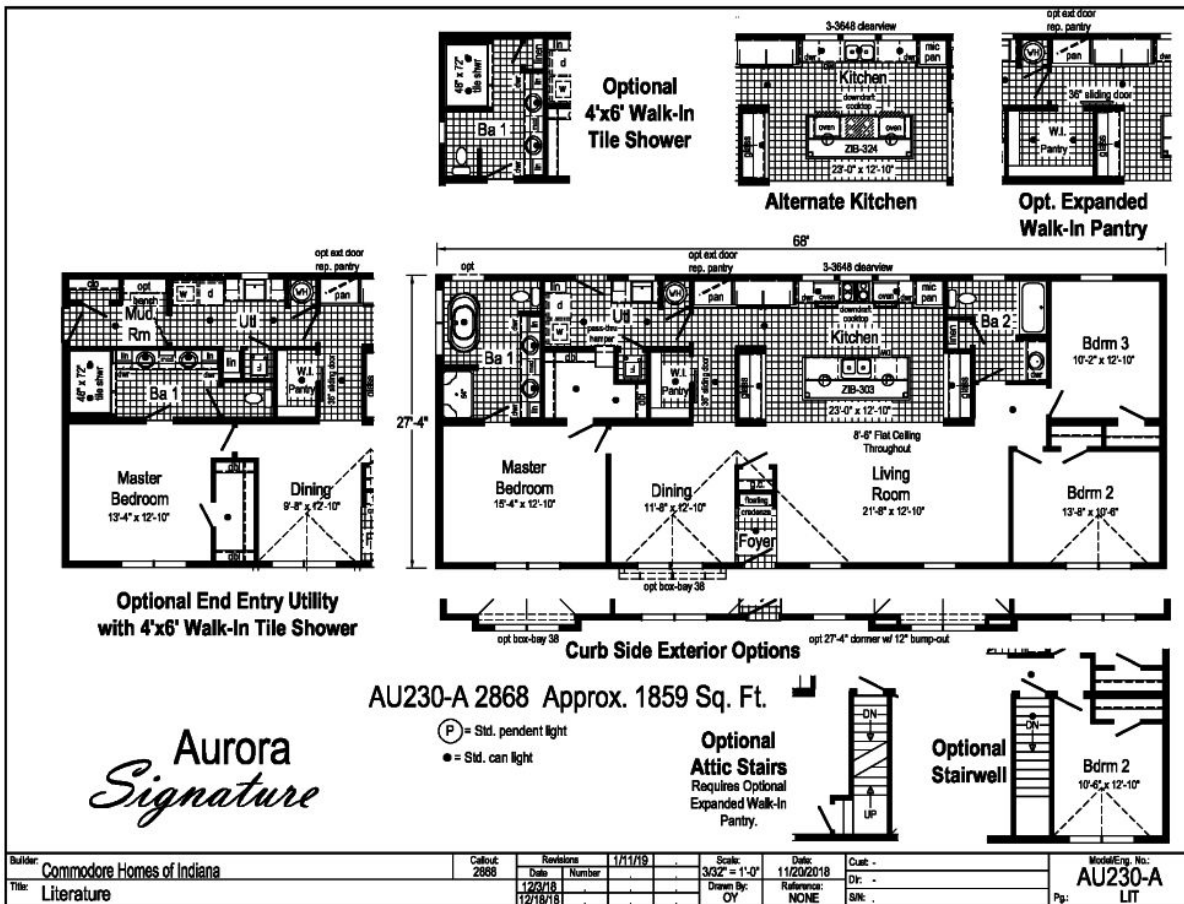

CUSTOMER CONTACT

Notes: _____

PRINTABLE INFO SHEET

**Series: Aurora Classic Ranch
Modular
Model: AU230A Aurora Signature**



Standards & Features

Interior

Smooth Drywall Throughout
Flat Ceiling with 8' Sidewall Throughout
Stipple Ceiling
Coveless Ceiling Joints
Brushed Nickel Langford 5-Arm Dining Room Light
Brushed Nickel Langford 3-Arm Nook Light
Glass Light Shades Throughout
6-Panel Interior Doors Through-out
Pre-Hung Door Jambs
Mortise Door Hinges
Metal Interior Passage Sets
Floor Mount Door Stops
Smoke Detectors with Battery Back-Up
Wire Shelving in All Closets
Brushed Nickel Interior Package
Includes: Door Handles, Hinges, Huntington
Brass Metal Faucets and Cabinet Hardware

Exterior

Prairie Lantern Light at Front Door
Patina Square Light at Rear Door
Two GFI-Protected Exterior Receptacles
Vinyl Dutch Lap Siding dropped down to
Cover Sill Plate
O.S.B. Sheathing with House Wrap Under Siding
5/12 Roof Pitch
7/12 Roof Pitch on AU187A
16" Fixed Eaves on All 28 and 42 wides
12" Fixed Eaves on All 32 wides
Architectural Shingles
Ridgevent Roof Ventilation System

Exterior (continued)

3/0 x 6/8 Fiberglass 4-Lite Classic Oak Front Door
with Deluxe Dexter Door Handle with Deadbolt
3/0 x 6/8 Fiberglass 6-Panel Rear Door Handle
with Deadbolt
Keyed-Alike Locksets
Vinyl Insulated Windows with Low-E Glass
and Grids
Double and Triple Windows are Mullied
12" Raised Panel Shutters on Front Door Side

Construction

2x10 Floor System on 16"
Centers**
3/4" Tongue and Groove OSB Floor Decking
2x10 Double Rim Joist
2x6 Exterior Walls on 16" Centers**
2x4 Interior Walls on 16" Centers**
40# Roof Load

Kitchen

High Rise Kitchen Sink Faucet
GE 30" Free Standing Gas Range with Electronic
Ignition
Power Range Hood with Light
GE 18 Cubic Foot, No-Frost Refrigerator with
Ice Maker
Refrigerator Surround
Stainless Steel Single Bowl Sink (33x22x8)
USB Recept

Baths

60" One-Piece Fiberglass Tub/Showers
One-Piece Fiberglass Shower with Glass Door in

CUSTOMER CONTACT

Notes:

PRINTABLE INFO SHEET



**Series: Aurora Classic Ranch
Modular
Model: AU230A Aurora Signature**

Standards & Features (continued)

Baths (continued)

- Glamour Baths
- Fiberglass Drop-in Tub in Glamour Baths
- Tub Overflows
- 1.6 Gallon Per Flush Elongated Toilets
- China Stool, Tank, and Lid
- China Sinks with Overflows and Pop-Up Drains
- Lighted Vent Fan in Each Bath
- Plant Made Recessed Medicine Cabinet in Master Bath in Most Models
- Anti-Scald Valves on Showers & Tubs

Cabinetry

- Evermore Custom Cabinetry (KCMA Certified)
- Hardwood Oak or Driftwood Mission Flat Panel Cabinet Doors
- Hardwood Cabinet Stiles
- Contemporary Cabinet Hardware
- Concealed Cabinet Hinges
- Crown and Under Cabinet Moulding on Overhead Cabinets
- 30"/42" Staggered Height Overhead
- Lined Overhead Cabinets
- Adjustable Shelves in Base and Overhead Cabinets
- Refrigerator Surround with 24" Deep Overhead Cabinet
- Single Drawer Over Double Door Base Cabinets
- Dovetail Drawer Construction
- Full Extension 75# Drawer Guides on all Drawers
- Base and Center Shelves in Base Cabinets
- Wilson Art Laminate Countertops with Bevel or Crescent Edging
- 4" Wilson Art Laminate Backsplash
- Tip-Out Trays at Sink
- Base Shelf in Vanities

Cabinetry (continued)

36" High Vanities in Master Bath

Utilities

- 200 AMP Electrical Service & 40/40 Box
- Copper Wiring Throughout
- 95 Plus Efficient Gas Furnace with:
 - 6-Panel Furnace Door
 - Fiberglass Heat Ducts
 - Perimeter Heat System
 - Ceiling Air Return System
- Air Conditioning Thermostat with 5-Wires
- 40 Gallon Electric Water Heater with Pan
- Main Water Line Shut-Off Valve
- Water Shut-Off Valves-Where Accessible
- Plumb and Wire for Washer
- Wire and Vent for Dryer
- MO-89 Cabinet Over Washer & Dryer Area
- One Exterior Water Faucet

Insulation

- R-19 Fiberglass Insulation in Walls
- R-38 Avg. Blown Insulation in Ceiling

Flooring

- Choice of Various Styles of SHAW Carpet with R2X Soil and Stain Resistance
 - 3 Styles: New Day, Believe It, and Adaptation
 - Choice of 12 Standard color options and numerous optional colors
 - Standard Carpets are all 25 oz
- Rebond Carpet Pad with Tackstrip Carpet Installation
- No-Wax Vinyl Floor Coverings, featuring Congoleum
- Entry Foyer Vinyl Flooring, featuring Congoleum

CUSTOMER CONTACT

Notes: _____

PRINTABLE INFO SHEET

Series: Aurora Classic Ranch

Modular

Model: AU230A Aurora Signature



Standards & Features (continued)

Bedrooms

Ceiling Lights

Egress Window Each Bedroom

Wire Shelving in Wardrobes

30" Interior Passage Doors

Switched Light in All Walk-In Closets

Energy Efficient Standards Include:

-Low-E Vinyl Insulated Windows

-95+ Efficient Gas Furnace

-Fiberglass Heat Ducts

- Fiberglass Exterior Doors

-R-38 ceiling insulation (avg.) and R-19 wall insulation

CUSTOMER CONTACT

Notes:
