

PRINTABLE INFO SHEET

Series: Grandville LE Modular Ranch

Model: RG780A Limited - 3



About This Model

Style: Ranch / Bedrooms: 3 / Bathrooms: 2 / Square Feet: 1600

CUSTOMER CONTACT

Notes:

PRINTABLE INFO SHEET

Series: Grandville LE Modular Ranch
 Model: RG780A Limited - 3



Floorplan

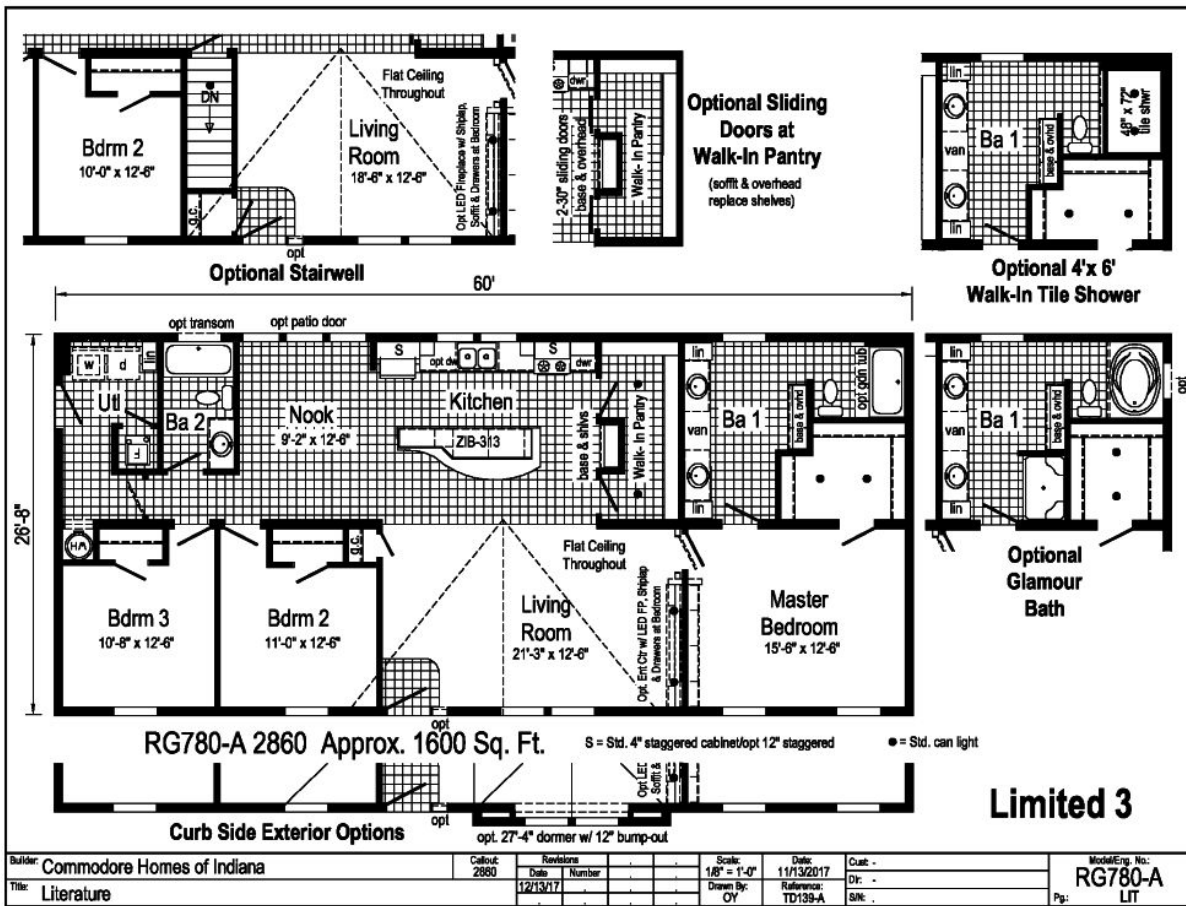

CUSTOMER CONTACT

Notes:

PRINTABLE INFO SHEET

Series: Grandville LE Modular Ranch
Model: RG780A Limited - 3



Standards & Features

Interior

Smooth Drywall Throughout
Flat Ceiling Throughout
Stipple Ceiling
Coveless Ceiling Joint
8'0" Sidewall Height
Alabaster Glass Pendant Nook Light
Glass Light Shades Throughout
Mortise Door Hinges
Metal Interior Passage Sets
Floor Mount Door Stops
Smoke Detectors with Battery Back-Up
Wire Shelving in Guest Closet
Brushed Nickel Interior Package
Includes: Door Handles, Hinges,
Huntington Brass Metal Faucets and
Cabinet Hardware

Exterior

Patina Lantern Light at Front Door
Patina Square Light at Rear Door
Two GFI-Protected Exterior Receptacle
Vinyl Dutch Lap Siding with Larger
Starter Strip to Cover Sill Plate
O.S.B. Sheathing
Fixed Roof with Shingles & 10" Eaves
Ridgevent Roof Ventilation System
3/0 x 6/8 6-Panel Fiberglass Front and
Rear Door with Deadbolt Lock
Vinyl Insulated Low-E Windows
12" Raised Panel Shutters on Front Door Side

Construction

2x10 Floor System on 16"
Centers**
2x6 Exterior Walls on 16" Centers**
2x4 Interior Walls
40# Roof Load

Kitchen

GE 30" Standard Free Standing Gas
Range with Electronic Ignition
Power Range Hood with Light
GE 18 Cubic Foot, No-Frost Refrigerator
with Icemaker
Stainless Steel Double Bowl Sink (33x22x8)
One USB Recept

Baths

60" One-Piece Fiberglass Tub/Showers
One-Piece Fiberglass Shower with
Glass Door in Glamour Baths
Fiberglass Soaker Tub in Glamour Baths
Anti-Scald Valves on Showers & Tubs
Tub Overflows
1.6 Gallon Per Flush Elongated Toilets
China Stool, Tank, and Lid
China Sinks with Overflows and Pop-Up Drains
Lighted Vent Fan in Each Bath
Factory Framed Mirrors & All Baths

Cabinetry

Evermore Custom Cabinetry (KCMA Certified)
Hardwood Oak Mission Flat Panel Cabinet Doors
Crown Moulding on Overhead Cabinets
Contemporary Cabinet Hardware

CUSTOMER CONTACT

Notes:

PRINTABLE INFO SHEET

Series: Grandville LE Modular Ranch
Model: RG780A Limited - 3



Standards & Features (continued)

Cabinetry (continued)

- 30" Height Overhead Cabinets
- Adjustable Shelves in Overhead Staggered Cabinets
- Dovetail Drawer Construction
- Full Extension 75# Drawers Guides
- Base and Center Shelf in Base Cabinets
- 25" Wilson Art Laminate Countertops with Laminate Edging
- 4" Wilson Art Laminate Backsplash
- 33" High Vanities
- Base Shelf in Vanities

Utilities

- 200 AMP Electrical Service
- Copper Wiring Throughout
- 95 Plus Efficient Gas Furnace
 - Woodgrain Furnace Door
 - Fiberglass Heat Ducts
 - Air Return System
- Air Conditioning Thermostat with 5-Wires
- 40 Gallon Electric Water Heater with Pan
- Main Water Line Shut-Off Valve
- Water Shut-Off Valves (Where Accessible)
- Plumb and Wire for Washer
- Wire and Vent for Dryer
- One Exterior Water Faucet

Insulation

- R-19 Fiberglass Insulation in Walls
- R-38 Avg. Blown Insulation in Ceiling

Flooring

Choice of Various Styles of SHAW Carpet

Flooring (continued)

- with ShawGuard Carpet Protector
- 3 Styles: Mantra, Standout or It's Cozy
- Choice of Several Standard color options and numerous optional colors
- Standard Carpets are all 16 or 18 oz Nylon
- Rebond Carpet Pad, with Tackstrip
- Installation
- Congoleum No-Wax Vinyl Floor Coverings
- Congoleum Entry Foyer

Bedrooms

- Ceiling Lights
- Egress Window Each Bedroom
- Wire Shelving in Wardrobes
- Switched Light in All Walk-In Closets

Energy Efficient Standards Include:

- Low-E Vinyl Insulated Windows
- 95+ Efficient Gas Furnace
- Fiberglass Heat Ducts
- Fiberglass Exterior Doors
- R-19 Fiberglass Insulation in Walls
- R-38 Avg. Blown Insulation in Ceiling

CUSTOMER CONTACT

Notes:
